

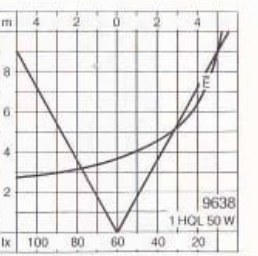

Opening without tools ▶

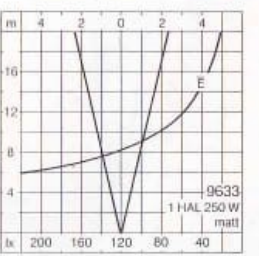
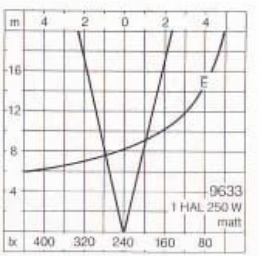
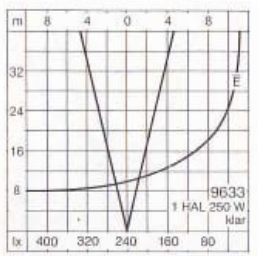
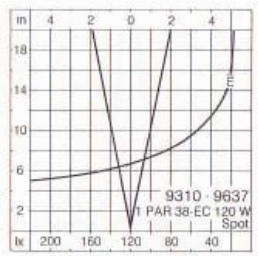
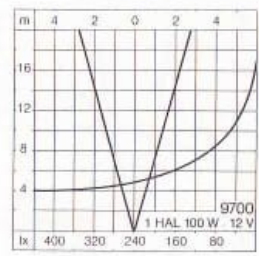
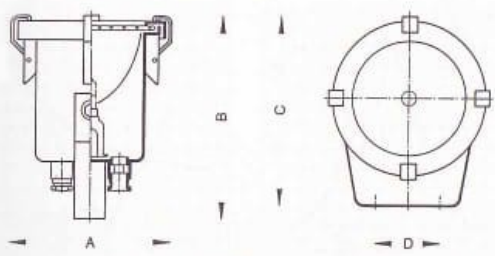

Underwater floodlight for

- 1 low voltage tungsten halogen lamp 12 V 100 W · 2500 lumen
- 1 incand. lamp PAR 38-EC 60 · 80 · 120 W 600 · 800 · 1200 lumen
- 1 tungsten halogen lamp E 27 · 150 · 250 W 2500 · 4200 lumen
- 1 discharge lamp MBF 50 W 2000 lumen · with ballast

Protection class IP X8 2 bar ▲▲ 20 m
 Stainless steel, electro-polished · Safety glass
 Reflector in anodized pure aluminium
 2 M 24x1.5 cable glands for waterproof cable
 Bracket with 1 central hole, ø 22.5 mm and 2 holes, ø 11.5 mm · Spacing D
 Coloured disks for coloured light.

	Lamp	Angle	A	B	C	D
970	1 HAL 12 V 100 W	19°	200	255	235	80
963	1 PAR 38-EC 120 W	12° · 30°	200	255	235	80
963	1 E 27 HAL 250 W	14°	230	280	260	100
963	1 MBF 50 W	60°	230	280	260	100

254 green **255** blue **256** yellow **257** red Coloured disks for 9637 · 9700

