



## FLOODLIGHTS, 150-1000W HID



Class I, Div. 2 Groups A,B,C,D®  
 Class I, Zone 2, Groups IIC, IIB, IIA (nR)Ⓣ  
 Suitable for wet locations  
 NEMA 4X  
 IP66

ABS Type Approval

SP US Type approval for shipboard useⓉ

### FEATURES-SPECIFICATIONS

#### Applications

KF series floodlights can be used in industrial installations where flammable gases or vapors may exist due to abnormal conditions resulting in the creation of a Class I, Div. 2 hazardous location as defined by the NEC. Also can be used where general corrosive atmospheric conditions exist such as ocean piers, marinas and costal areas.

Designed for heavy duty applications where long life and maintenance-free service are essential.

#### Features

- Rugged weathertight housing of copper-free aluminum with corrosion resistant bronze finish
- Wide beam distribution
- Thermal shock, impact-resistant lens
- Continuous silicone gasketing
- All external hardware is corrosion resistant including HubbellGard® ceramic coated screws
- Trunnion mounting-heavy gauge, hot dip galvanized steel mounting with stainless steel hardware
- 3/4" NPT entry on back lower left

#### Catalog Logic

KF P 40 0 -76 NR F1 P1 AS

1 2 3 4 5 6  
 1 **KF - Series Constant** (aluminum flood)

#### Lamp Type

S = High Pressure Sodium  
 H = Metal Halide  
 P = Pulse Start Metal Halide

#### Wattage

07 = 70 Watt (HPS)  
 10 = 100 Watt (HPS)  
 15 = 150 Watt (MHP, HPS)  
 17 = 175 Watt (MH, MHP)Ⓣ  
 20 = 200 Watt (MHP)  
 25 = 250 Watt (MH, MHP, HPS)Ⓣ  
 32 = 320 Watt (MHP)  
 35 = 350 Watt (MHP)  
 40 = 400 Watt (MH, MHP, HPS)Ⓣ  
 100 = 1000 Watt (MH, HPS)mno

#### Voltage\*1

0 = Quad - 120, 208, 240, 277V - 60Hz  
 5 = 480V  
 6 = Tri - 120, 277, 347V (for Canada only)  
 7 = 220V 60Hz  
 8 = 220/240V 50 Hz

#### -76 Series Constant (7 x 6 optic pattern)

#### Options

- NR - Ex nR Restricted Breathing (Ex nR II)
- IR - Instant Restrike 150W HPS\*\*
- BP - 150 - 400 HPS\*\*
- Fuse option 400W max. (not for Marine or CSA)
- F1 single 120V      F5 double 480V
- F2 double 208V      F6 single 347V
- F3 double 240V      F7 double 220V
- F4 single 277V      F8 single 230V

50Hz

#### Photocell option (400W max.)

P1 120V    P2 208-277V    P2 347V

#### Terminal Blocks

TBx x=1-8      x = voltage code  
 TBLx Lx=1-8 loopingx = voltage code

#### Lamps

AS = Assembled Standard Lamp  
 AD = Assembled Dual-Arc-Tube Lamp;  
 150, 250, 400HPS only

Ⓣ Not suitable for submersion or wave impact.

Ⓣ MH175,250,400 are EXPORT ONLY (EISA LAW).

Ⓣ Consult factory for other available voltage/lamp combinations.

Ⓣ 1000 Watt fixture aiming angle limited to 45°-135° (no straight up or down) 1000 Watt fixtures are rated and listed for 40° ambient.

Ⓣ Use Phillips C1000S52/ED37 11-1/2" lamp for 1000 HPS.

Ⓣ Use 11-1/2" BT37 lamp available from GE, Venture or Phillips (MH).

Ⓣ NR suffix Restricted Breathing models provide lower T-codes - Requires sealed entry.

Ⓣ Consult T-code chart for suitability.  
 T-Codes=>306 are suitable for Groups B,C,D only.

\*\* IR & BP cannot be ordered together.



Elevated Ambients to 55°C

Consult T-Code Chart for suitability.

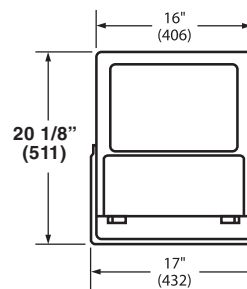

Front

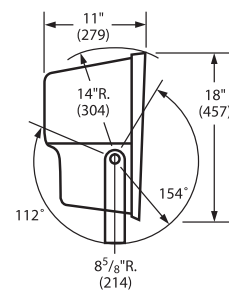

Side

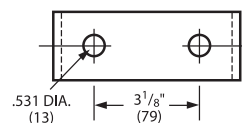

Trunnion Mounting Detail



# LIGHTING

## ORDERING INFORMATION • ACCESSORIES



KFS-6



KFCB



KFWB



K4040



4041

### ORDERING INFORMATION

MH, PULSE START ORDERING INFORMATION*			
CATALOG NUMBER	LAMP AND WATTAGE	VOLTS ④	BEAM SPREAD H° X V°
KFP150-76 KFP155-76	150 MHP M-102/142	QUAD 480	7 (145°) X 6 (114°)
KFP170-76 KFP175-76	175 MH M-137/152	QUAD 480	7 (145°) X 6 (114°)
KFP200-76 KFP205-76	200 MH M-136	QUAD 480	7 (145°) X 6 (114°)
KFP250-76 KFP255-76	250 MHP M-138	QUAD 480	7 (145°) X 6 (114°)
KFP320-76 KFP325-76	320 MHP M-132	QUAD 480	7 (145°) X 6 (114°)
KFP350-76 KFP355-76	350 MHP M-131	QUAD 480	7 (145°) X 6 (114°)
KFP400-76 KFP405-76	400 MHP M-135	QUAD 480	7 (145°) X 6 (114°)

KF MOUNTING ACCESSORIES ①	
CATALOG NUMBER	DESCRIPTION
KFS-6	Steel slipfitter for 2" pipe (2-3/8" o.d.) tenon. Slips 3.75" over pipe
KFCB	Heavy duty cast-iron crossarm fitting for horizontal trunnion
KFWB	Heavy duty wall mount and/or pipe clamp fitting Clamps 2" pipe (2-3/8" o.d.) thru 2-1/2" pipe (2-7/8" o.d.)
K4040	Heavy duty steel wall bracket. (Must use with KFCB crossarm fitting)
4041	Heavy duty steel wall bracket 2" pipe (2-3/8" o.d.) tenon fitting
KF-DOOR	Replacement Door & Lens assembly

① Fittings available to adapt trunnion mount floodlights to crossarms, poles and walls. Must be ordered separately.

HPS, MH, START ORDERING INFORMATION*				
CATALOG NUMBER	LAMP AND WATTAGE	VOLTS ④	BEAM SPREAD H° X V°	
KFS070-76 KFS075-76	70 HPS S-62	QUAD 480	7 (144°) X 6 (113°)	
KFS100-76 KFS105-76	100 HPS S-54	QUAD 480	7 (145°) X 6 (114°)	
KFS150-76 KFS155-76	150 HPS S-55	QUAD 480	7 (144°) X 6 (113°)	
KFS250-76 KFS255-76	250 HPS S-50	QUAD 480	7 (144°) X 6 (113°)	
KFS400-76 KFS405-76	400 HPS S-51	QUAD 480	7 (144°) X 6 (113°)	
KFS1000-76 KFS1005-76	1000 HPS S-52 ④⑤	QUAD 480	7 (130°) X 6 (114°)	
EXPORT ONLY	KFH170-76 KFH175-76	170 MH M-57	QUAD 480	7 (145°) X 6 (114°)
	KFH250-76 KFH255-76	250 MH M-58	QUAD 480	7 (145°) X 6 (114°)
	KFH400-76 KFH405-76	400 MH M-59	QUAD 480	7 (146°) X 6 (119°)
	KFH1000-76 KFH1005-76	1000 MH M-47 ④⑥	QUAD 480	7 (145°) X 6 (114°)

\* Consult T-Code Chart for hazardous location suitability.

④ Consult factory for other available voltages.

⑤ 1000 watt fixture aiming angle limited to 45°-135° (no straight up or down) 1000 watt fixtures are rated and listed for 40° ambient.

⑥ Use Philips C1000S52/ED37 11-1/2" lamp.



APPLICATION DATA • PHOTOMETRICS

HAZARDOUS LOCATION APPLICATION DATA					
LUMINAIRE WATTAGE	AMBIENT	C1D2 T-CODE <sup>①</sup>	C1Z2NR T-CODE <sup>②</sup>	SUPPLY WIRE C°	AIMING RANGE & DIAGRAM <sup>③</sup>
70W HPS	40C	T2B	T4	75	180° - 0° A
	55C	T2B	T4	75	180° - 0° A
	65C	T2B	T4	90	180° - 0° A
100W HPS	40C	T2B	T4	75	180° - 0° A
	55C	T2B	T4	75	180° - 0° A
	65C	T2B	T4	91	180° - 0° A
150W HPS	40C	T2B	T4	75	180° - 0° A
	55C	T2B	T4	90	180° - 0° A
	65C	T2B	T4	105	180° - 0° A
250W HPS	40C	325C	T4	90	180° - 0° A
	55C	325C	T3	105	180° - 0° A
	65C	325C	T3	105	135° - 0° B
400W HPS	40C	357C	T3	90	180° - 0° A
	50C	363C	T3	105	135° - 0° B
	55C	XXX	XXX	NA	XXX NA
1000W HPS	40C	T1	T2	110	135°-45° C
	55C	XXX	XXX	NA	XXX NA
	65C	XXX	XXX	NA	XXX NA
175MH	40C	350C	T4	90	180° - 0° A
	55C	350C	T3	105	180° - 0° A
	65C	325C	T4	105	135° - 45° C
250W MH	40C	350C	T4	90	180° - 0° A
	55C	350C	T3	105	180° - 0° A
	65C	325C	T4	105	135° - 45° C
400W MH	40C	325C	T3	105	135° - 0° B
	55C	301C	T3	105	90° - 45° D
	65C	XXX	XXX	NA	XXX NA
1000W MH	40C	442C	T2	110	135°-45° C
	55C	XXX	XXX	NA	XXX NA
	65C	XXX	XXX	NA	XXX NA
150W MHP	40C	325C	T4	90	180° - 0° A
	55C	325C	T3	90	180° - 0° A
	65C	325C	T3	105	180° - 0° A
175W MHP	40C	325C	T4	90	180° - 0° A
	55C	325C	T3	90	180° - 0° A
	65C	325C	T4	105	180° - 0° A
200W MHP	40C	325C	T4	90	180° - 0° A
	55C	325C	T3	90	180° - 0° A
	65C	325C	T5	105	180° - 0° A
250W MHP	40C	350C	T3	90	180° - 0° A
	55C	350C	T3	105	180° - 0° A
	65C	XXX	XXX	NA	180° - 0° NA
320W MHP	40C	366C	T3	90	180° - 0° A
	55C	366C	T3	105	180° - 0° A
	65C	XXX	XXX	NA	XXX NA
350W MHP	40C	350C	T3	90	180° - 0° A
	55C	350C	T3	105	135° - 45° C
	65C	XXX	XXX	NA	XXX XXX
400W MHP	40C	350C	T3	90	180° - 0° A
	55C	325C	T3	105	135° - 45° C
	65C	XXX	XXX	NA	XXX XXX

PHOTOMETRIC DATA  
KF SERIES

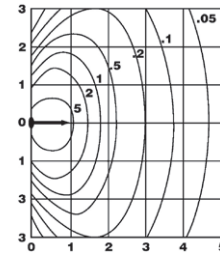

**KFH-XXX-76**

IES Type—7H x 6V (146° x 119°)  
Source—Metal Halide (Clear) 34000 Lumens  
Wattage—400 (ANSI M59)  
For 250W MH multiply by .6  
For 1000W MH multiply by 3.1  
Mounting Height (Grid Value)—25 feet  
Aiming Angle—45°  
Test Number—HP-00738

CONVERSION CHART					
MOUNTING HEIGHT (FEET)	20	25	28	30	35
CORRECTION FACTOR	1.56	1	0.80	0.69	0.51

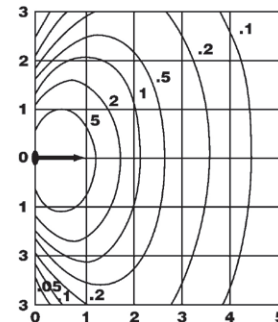

**KFS-XXX-76**

IES Type—7H x 6V (144° x 117°)  
Source—High Pressure Sodium (Clear) 50000 Lumens  
Wattage—400 (ANSI S51)  
For 150W HPS multiply by .32  
For 250W HPS multiply by .6  
For 1000W HPS multiply by 2.5  
Mounting Height (Grid Value)—25 feet  
Aiming Angle—45°  
Test Number—HP-00740

CONVERSION CHART					
MOUNTING HEIGHT (FEET)	23	25	30	35	40
CORRECTION FACTOR	1.18	1	0.69	0.51	0.39

Aiming Figures Based on Ambient & Lamp<sup>③</sup>

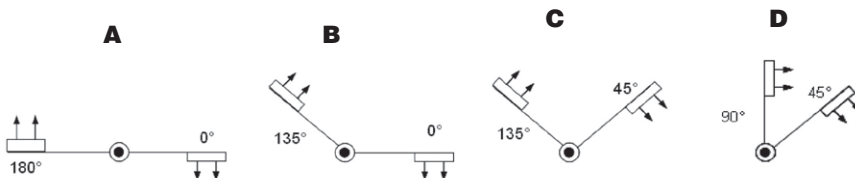

- ① Temperatures equal or higher than 306°C are suitable for Groups B,C,D only.
- ② C1D2 NR Restricted Breathing requires Sealed Entry.
- ③ Aiming angle limited by ambient temperature and lamp type - See Diagrams.

① In converting to a different mounting height, multiply all footcandle values by the correction factor and convert the grid size to the mounting height selected. Example: to convert 25 foot to 30 foot mounting height, multiply all footcandle values by .69. (Grid now becomes 30 replacing 25). To convert footcandle values to Lux, multiply values by 10.76. To convert feet to meters, divide values by 3.281.